



GT DBL228 21.5” Desktop Touchmonitor

Combined with optical bonding technology, GT DBL228 Commercial-grade 21.5” desktop Touchmonitor delivers a better visual experience and a more realistic touch experience than traditional air bonding. The enhanced clarity, brightness, and remarkable vivid image, only require much less power consumption.

With the unique widescreen and narrow border design, DBL228 allows more content on the screen than the standard with an even smaller and more artistic outline. GT DBL228 features multiple interfaces and flexible mounting, easy connection to various devices, and installation into the cabinet. It’s an ideal touch solution for retail, hospitality, transportation, and other industries.

Features & Benefits

- Optical bonding, excellent visual and touch experience
- X-Trim, elegant design with narrow border
- PCAP 10-point multitouch technology
- Desktop touch monitor
- HDMI/USB-A, multiple interfaces
- Anti-scratch, and pass UL Ball Drop test & IK07

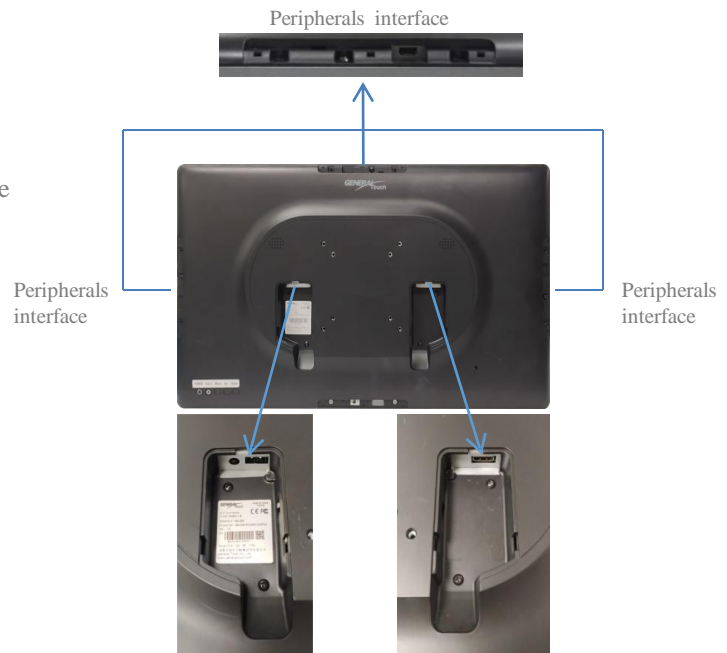

Applications

- Retail
- Office
- Medical
- Finance
- Self-service
- Gaming
- Transportation

SPECIFICATIONS

Name	21.5 Inch Desktop Touch Monitor
Model	DBL228
LCD Panel Parameters	
Display Technology	Active Matrix TFT-LCD with LED Backlight
Aspect Ratio	16:9
Active Area (W x H)	476.64×268.11 mm
Native Resolution	1920×1080@60Hz
Response Time (Typ.)	14ms
Display Colors	16.7million
Luminance (Typ.)	250nits; with PCAP 210nits
Contrast Ratio (Typ.)	1000:1
Viewing Angle (Typ.)	Horizontal (left/right) CR≥10 89°/89°
	Vertical (up/down) CR≥10 89°/89°
Touch Screen Parameters	
Touch Technology	Projected Capacitive (PCAP)
Surface Treatment	Strengthened
	Optional: Anti-Glare
Active Area(W x H)	477.0×268.6±0.3 mm
Thickness(Total)	2.6±0.3 mm
Light Transmission	≥83%
Response Time	8ms
Touch Screen Interface	USB
Touch Point	10
Overall Parameters	
Case/Bezel Color	Black
Mounting Options	VESA: 100×100 mm, 75×75 mm
Outline Dimensions (W×H×D)	505.2 mm × 296.8 mm× 36.8 mm (Without Base)
	505.2 mm × 350.1 mm× 233.2 mm (With Base)
Power Supply	External Adapter: 100-240V AC, 50-60 Hz Input Voltage Range: +12VDC ± 5%
On Screen Display (OSD)	Control (back): Power, Auto, Up, Down, Menu
Power Consumption (Typ.)	20W
Speaker	2*2W
Webcam	NA (Optional)

Operating Altitude	≤3000m
Temperature Range	Operating: 0°C to 40°C, storage: -20°C to 60°C
Humidity (Non Condensing)	Operating: 20% to 80%, storage: 10% to 90%
I/O	HDMI, USB (Type A)
Accessories	Cable: USB × 1, 1.5m Length
Carton Box Dimensions	TBD
Weight	Net: 4.56kg Gross: 12.62kg
MTBF	50,000 hours demonstrated
Agency Approvals	CCC, CE , FCC
Warranty	3 years

Ordering Information

Model	Part Number	Description
DBL228-RC3000-UH2F0S-1.0	TBD	21.5", 16:9, 250nits, P-Cap, USB, HDMI, Black, Desktop

Contact sales for other options

Optional Accessories

Model	Part Number	Description
Adaptor	130102978R	12V/4.17A, DC Cable: 1500mm, DC Jet Ø2.5mm
	130300338R	UK
Power Cord	130300339R	EU 1500mm
	130300340R	US
HDMI Cord	130300881R	1500mm

Go to www.generaltouch.com for more products and information, or contact us.

General Touch Co., Ltd. reserves the right to change or update, without notice, any information contained herein; to change, without notice, the design, construction, materials, processing or specifications of any products; and to discontinue or limit production or distribution of any products.

Tel: 0086-28-85124120

Fax: 0086-28-85124115

E-mail: info@generaltouch.com

<http://www.generaltouch.com>